

Presence



Quick Guide
Kort vejledning
Kurzanleitung
Instrucciones resumidas
Guide rapide
Istruzioni brevi
Beknopte gebruiksaanwijzing
Krótka instrukcja obsługi



Package contents | Leveringsomfang | Lieferumfang | Volumen de suministro | Contenu | Dotazione | Omvang levering | Zakres dostawy

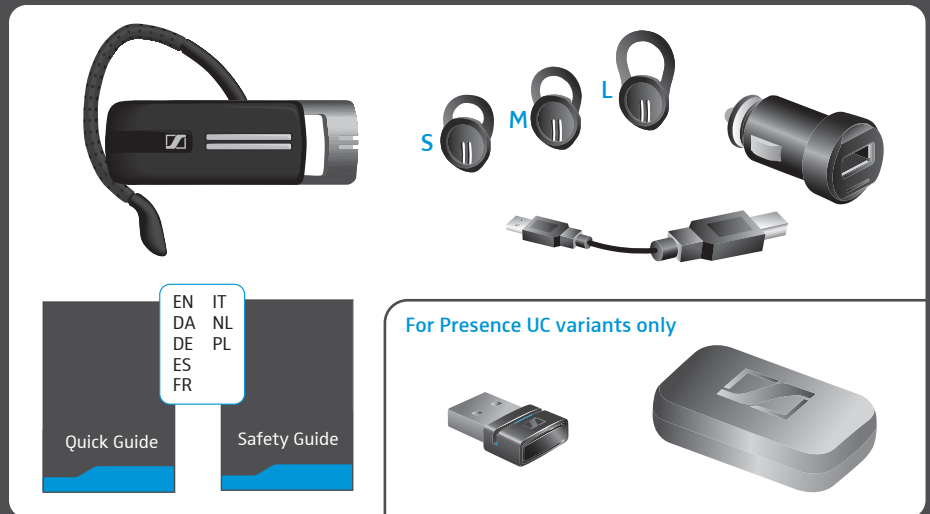

Charging the headset battery | Opladning af genopladeligt batteri | Akku laden | Cargar la pila recargable | Charger la batterie de l'oreillette | Caricamento della batteria | Accu laden | Ładowanie akumulatora

LED flashes	Meaning
1x [red dot]	below 1 hour talk time
1x [blue dot]	1 to 2 hours talk time
2x [blue dot]	4 to 2 hours talk time
3x [blue dot]	10 to 4 hours talk time
[blue dot]	100 %

If the headset is fully charged the LED lights up blue. After 5 minutes, the LED goes off. Press the multi-function button to check the battery charge level.

*not included

Fast charging | Hurtigoplading | Schnellladung | Carga rápida | Chargement rapide | Caricamento veloce | Snelladen | Szybkie ładowanie

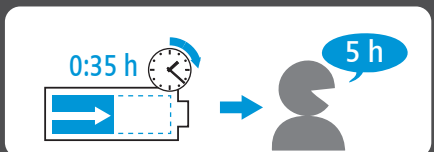

Retrieving information on the remaining talk time | Forespørgsel på resterende taletid | Verbleibende Sprechzeit abfragen | Consultar la autonomía restante | Vérifier le temps de communication restant | Richiesta del tempo di conversazione residuo | Resterende spreektijd opvragen | Wywołanie informacji o pozostałym czasie rozmowy

3x [blue dot] "Between 8 and 10 hours talk time"

3x [blue dot] "Between 4 and 8 hours talk time"

2x [blue dot] "Between 2 and 4 hours talk time"

1x [blue dot] "Between 1 and 2 hours talk time"

1x [red dot] "Less than 1 hour talk time"

below 15min talk time, automatic voice prompts: "Recharge headset"

Complete charging cycle | Full opladningsproces | Kompletter Ladevorgang | Proceso de carga completo | Cycle de charge complet | Processo di carica completo | Complete opladningscyclus | Kompletna operacja ładowania

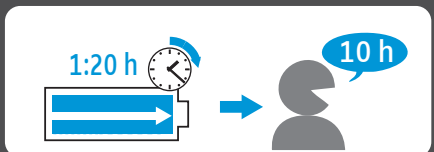

Pairing the headset | Forbindelse af hovedsættet | Headset verbinden | Conectar el headset | Appairer l'oreillette | Connessione dell'headset | De headset verbinden | Łączenie zestawu słuchawkowego

1. Activate the Bluetooth® function
press and hold while powering on
"Pairing"
2. Search for Bluetooth devices
"Add device"
3. Select the Presence on your device
"Presence Sennheiser VMX 200"
Presence Keyword: 0000
"Pairing successful"

Swapping the assignment of the volume buttons | Ændring af funktionen for lysterkeknappen | Belegung der Lautstärketasten tauschen | Cambiar la asignación de las teclas de volumen | Permuter la fonction des touches Volume+ et Volume- | Scambio dell'occupazione dei tasti volume | De functie van de volumetoetsen omwisselen | Zmiana głośności

2s Press both volume buttons to swap the +/- assignment of the volume buttons.

- During an active call - volume 1: Increases or reduces the speech volume
- During music reproduction - volume 2: Increases or reduces the music volume
- In idle mode (no active call or music reproduction) - volume 3: Increases or reduces the volume for the ring tone, the beeps and the voice prompts

Adjusting and wearing the headset | Tilpasning og brug af hovedsættet | Headset anpassen und tragen | Ajustar y llevar el headset | Ajuster et porter l'oreillette | Indossare e adattare l'headset | De headset aanpassen en dragen | Dostosowanie oraz noszenie zestawu słuchawkowego

Ear hook

Left Right

Ear adapter (S, M, L)

Left Right

1. Insert ear adapter
2. Attach ear hook
3. Insert into ear
4. Adjust fit

Switching the headset on/off | Hovedsæt On/Off | Headset ein-/ausschalten | Conectar/desconectar el headset | Allumer/éteindre l'oreillette | Accensione/Spengimento dell'headset | Headset On/Off | Włączenie/ Wyłączenie zestawu słuchawkowego

3x [blue dot] "Power on"

3x [red dot] "Power off"

1. "Power on"
2. "... connected" (see voice prompts)

Using the headset | Betjening af hovedsættet | Headset bedienen | Manejo del headset | Utiliser l'oreillette | Utilizzo dell'headset | Headset bedienen | Obsługa zestawu słuchawkowego

Call control features

- 2x [red dot] Redials the last number "Redialling"
- 1.5s [blue dot] Starts/stops voice dialing (press until you hear a beep, then release the button) "Voice dial"
- 1.5s [blue dot] Transfers a call from the mobile phone to the headset
- 1.5s [blue dot] Transfers a call from the headset to the mobile phone
- 2x [blue dot] Accepts the incoming call and puts an active call on hold. Puts an active call on hold when there is no incoming call (pause)
- 1.5s [red dot] Rejects the incoming call and continues the active call
- 1.5s [blue dot] Accepts the incoming call and ends the active call

Managing multiple calls

Mute function

- Mutes the microphone "Mute on"
- Unmutes the microphone "Mute off"

Automatic voice prompts

- Connected to the Bluetooth device: "Phone 1 connected" or "Phone 2 connected" or "Dongle connected"
- Out of the Bluetooth transmission range: "Phone 1 disconnected" or "Phone 2 disconnected" or "Dongle disconnected"