

INTRODUCTION

Model	Description
I36-200	60W high power PoE output

PACKAGE CONTENTS

* 1x PoE injector	* 1x AC power cord
* 1x Quick Installation Guide	

⚠ IMPORTANT:

1. Use CAT5 or 5e UTP/STP cables.
2. AC input (100~240V/AC, 50~60Hz, 3A)

CONNECTION

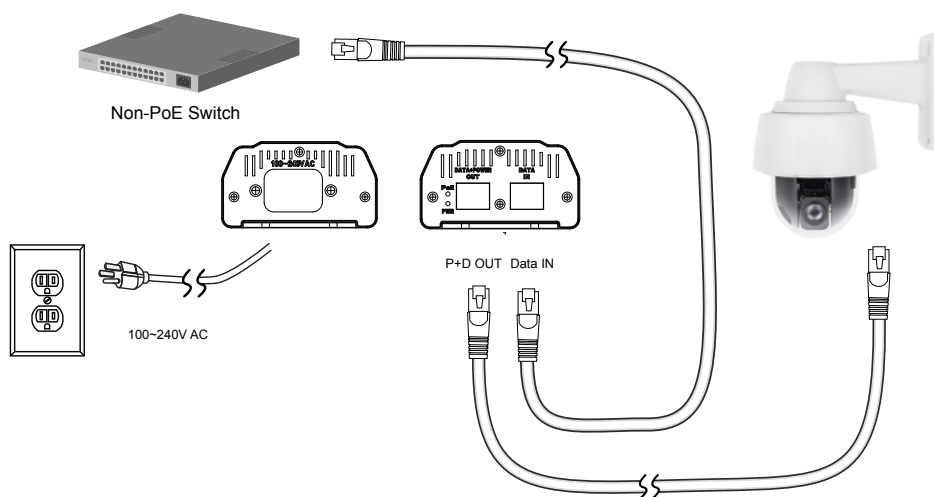

Installation Steps:

1. Connect the included AC power cord to the injector. The Power LED (Yellow) should be lit.
2. Connect the Data IN port to a LAN switch using an Ethernet cable.
3. Connect the Power+Data OUT port to a powered device, i.e., IP camera, using another Ethernet cable. Make sure the PoE LED (Green) is lit.
4. Check if the powered device (IP camera) is working properly. An IP camera may take up to 1 or 2 minutes to power up.